

## Basic Rack PDU

### **Rack PDU, Basic, 1U, 20A, 120V, (10)5-20; L5-20P**



APC Basic Rack PDU , Input: 120V , Input Connections: NEMA L5-20P , Cord Length: 12 feet ( 3.66 meters ) , Output: 120V , Output Connections: NEMA 5-20R

**Includes:** Installation guide, Rack Mounting brackets

**Standard Lead Time:** Usually in Stock



## AP9564 Features

19 inch Rack-Mountable	Supplies redundant AC power to connected equipment. Two AC lines power the unit and if the primary AC power fails, the unit will automatically switch to the alternate power source.
Vertical mounting capability	
Horizontal mounting capability	

## Basic Rack PDU Features & Benefits

Agility	
Rack-Mountable	Includes horizontal, vertical, and toolless-mount varieties. Puts power where it is needed most - in the racks near the equipment.
Single input power source	Supply power from one branch whip to multiple pieces of equipment, conveniently powering rack-mount equipment. Saves time and money during installation by using one branch whip and standard connections.
Wide range of input and output connections	Product family includes a variety of input and output connections to distribute 120V, 208V, or 230V power to multiple outlets. Having a variety of inputs and outputs allow users to adapt to varying power requirements. APC offers units that bring up to 14.4kW using a single branch whip.

# Output

Nominal Output Voltage	120V
Maximum Total Current Draw per Phase	20A
Output Connections	(10) NEMA 5-20R



# Input

Nominal Input Voltage	120V
Input Frequency	50/60 Hz
Regulatory Derated Input Current (North America)	16A
Input Connections	NEMA L5-20P
Cord Length	3.66 meters
Number of Power Cords	1
Maximum Input Current per phase	20A
Load Capacity	2400 VA



# Physical

Net Weight	2.50 KG
Maximum Height	44.00 mm
Maximum Width	447.00 mm
Maximum Depth	57.00 mm
Shipping Weight	3.64 KG
Shipping Height	70.00 mm
Shipping Width	464.00 mm
Shipping Depth	229.00 mm
Color	Black

# Environmental

Operating Environment	-5 - 45 °C
Operating Relative Humidity	0%
Operating Elevation	0-3000 meters
Storage Temperature	-25 - 65 °C

Storage Relative Humidity	0%
Storage Elevation	0-15000 meters

## Conformance

Regulatory Approvals	cUL Recognized,CSA,UL 1363,UL Recognized
Standard Warranty	2 years repair or replace
ROHS/WEEE Compliance	RoHS 7b Exemption

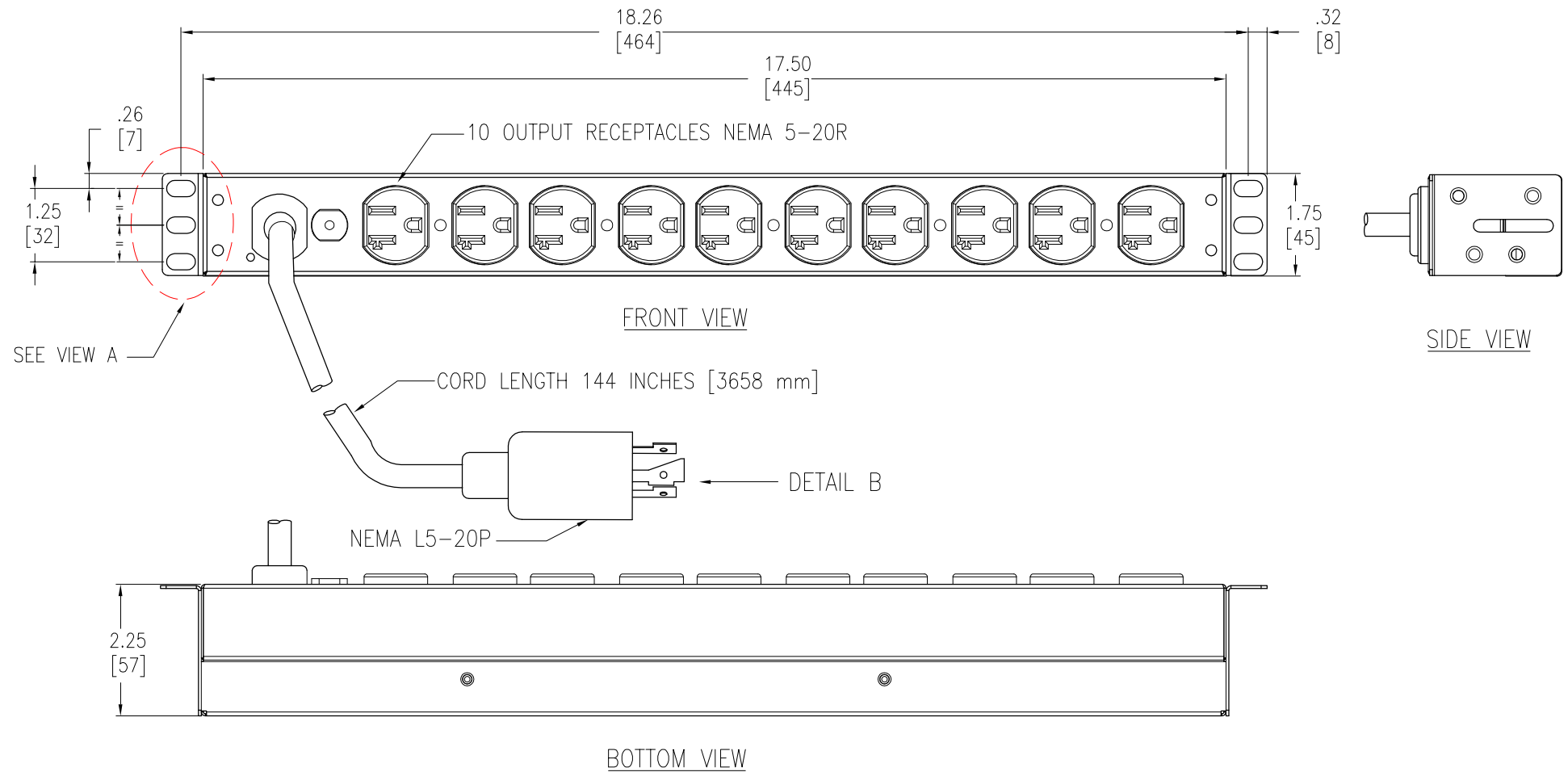
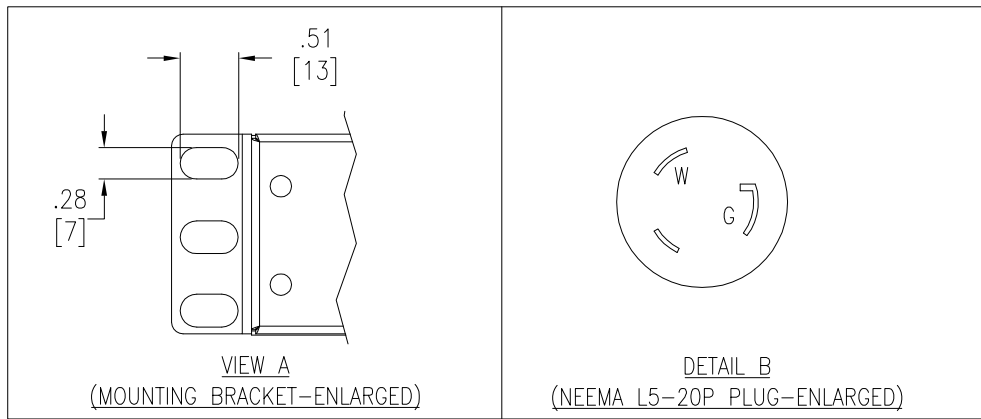

NOTES:

1. ALL DIMENSIONS ARE IN INCHES [MILLIMETERS].
2. NET WEIGHT IS 5.5 LBS [2.5 kg]
3. INSTALLATION MUST COMPLY WITH ALL APPLICABLE NATIONAL AND LOCAL CODES.

THIS DRAWING AND SPECIFICATIONS HEREIN ARE THE PROPERTY OF AMERICAN POWER CONVERSION AND SHALL NOT BE COPIED, REPRODUCED OR USED IN WHOLE OR IN PART, AS THE BASIS FOR THE MANUFACTURE OR SALE OF ITEMS WITHOUT WRITTEN PERMISSION FROM APC. THIS DRAWING IS BASED UPON LATEST AVAILABLE INFORMATION AND IS SUBJECT TO CHANGE WITHOUT NOTICE.

TITLE: RACK PDU, BASIC  
 1U, 20A, 120V, INPUT: NEMA L5-20P  
 OUTPUT: (10) NEMA 5-20R  
 MAIN MECHANICAL

PROJECT: SUBMITTAL DRAWINGS SHEET 1 OF 2

DWG NO: AP9564-MM1  
 REV: 1

DRAWN BY: JAYAPRAKASH  
 CHECKED BY: T.HORSTMANN  
 ENGINEER: J.RING/ E.SILVA



# ISOMETRIC VIEW

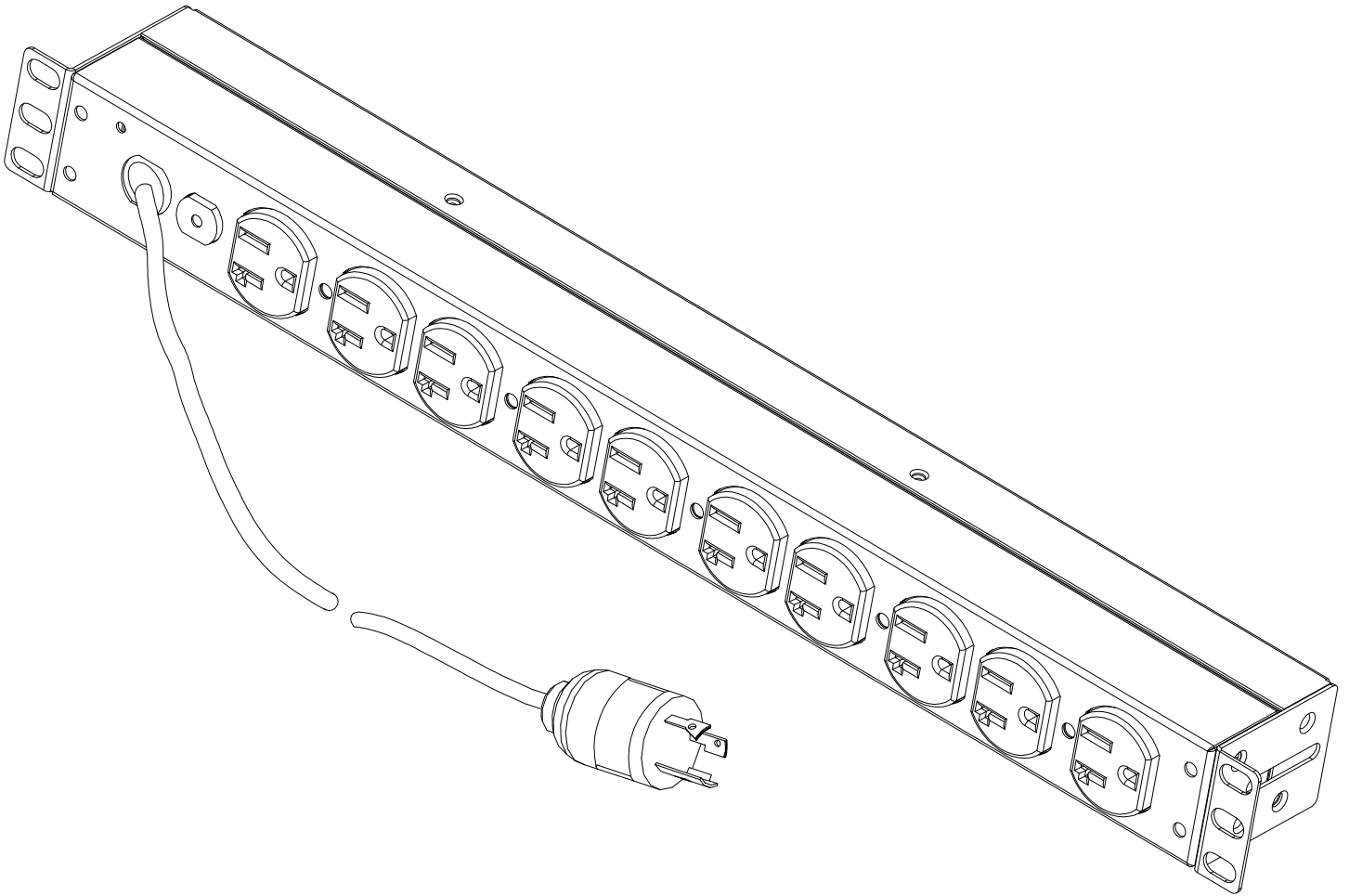

THIS DRAWING AND SPECIFICATIONS HEREIN ARE THE PROPERTY OF AMERICAN POWER CONVERSION AND SHALL NOT BE COPIED, REPRODUCED OR USED IN WHOLE OR IN PART, AS THE BASIS FOR THE MANUFACTURE OR SALE OF ITEMS WITHOUT WRITTEN PERMISSION FROM APC. THIS DRAWING IS BASED UPON LATEST AVAILABLE INFORMATION AND IS SUBJECT TO CHANGE WITHOUT NOTICE.

TITLE: RACK PDU, BASIC  
1U, 20A, 120V, INPUT: NEMA L5-20P  
OUTPUT: (10) NEMA 5-20R  
ISOMETRIC VIEW  
PROJECT: SUBMITTAL DRAWINGS SHEET 2 OF 2

DWG NO: AP9564-MM2 REV. 1  
DRAWN BY: JAYAPRAKASH  
CHECKED BY: T.HORSTMANN  
ENGINEER: J.RING/ E.SILVA





# Power Distribution Units AP9562, AP9563, and AP9564

---

AP9562, AP9563, and AP9564 are 15- and 20-amp Rack Power Distribution Units (PDUs) that provide 120-volt power to rack-mounted equipment.

## AP9562

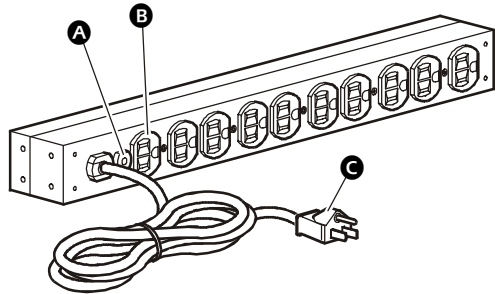

- A** 15-amp circuit breaker (1)
- B** NEMA 5-15 outlets (10)
- C** 12-foot NEMA 5-15 power cord

## AP9563

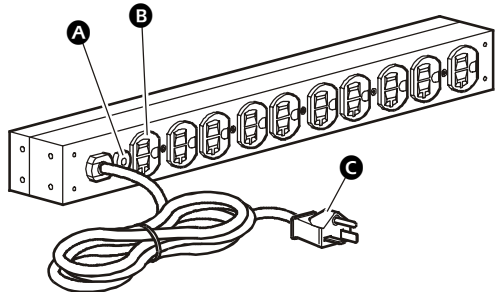

- A** 20-amp circuit breaker (1)
- B** NEMA 5-20 outlets (10)
- C** 12-foot NEMA 5-20 power cord

## AP9564

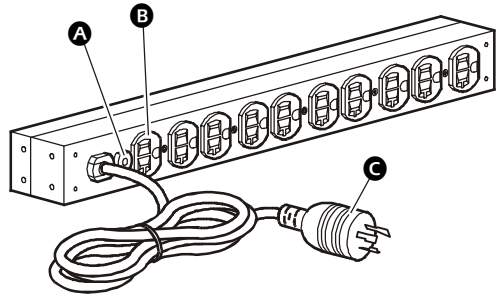

- A** 20-amp circuit breaker (1)
- B** NEMA 5-20 outlets (10)
- C** 12-foot NEMA L5-20 power cord

## Mounting brackets

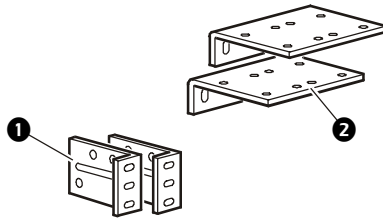

- 1** Brackets for horizontal mounting
- 2** Brackets for vertical mounting



### Note

Each PDU is packaged with two types of mounting brackets (for horizontal and vertical mounting). Choose your mounting orientation and attach the appropriate brackets to the PDU for installation.



# Specifications

---

	AP9562	AP9563	AP9564
<b>Electrical</b>			
Input voltage range	100–120 V		
Maximum current draw	15 A	20 A	20 A
<b>Physical</b>			
Size (h×w×d)	1.75×17.6×2.25 in (4.45×44.7×5.72 cm)		
Shipping size (h×w×d)	2.75×18.25×9.0 in (6.99×46.35×22.86 cm)		
Weight	5.5 lb (2.5 kg)		
Shipping weight	8.0 lb (3.6 kg)		
<b>Environmental</b>			
Elevation (above MSL)	Operating: 0–10,000 ft (0–3000 m) Storage: 0–50,000 ft (0–15 000 m)		
Relative humidity	Operating: 0 to 95%, non-condensing Storage: 0 to 95%, non-condensing		
Temperature	Operating: 23 to 113° F (–5 to 45° C) Storage: –13 to 149° F (–25 to 65° C)		
<b>Compliance</b>			
Safety	UL/cUL Recognized; UL 1363		